

## RC12 Ultrasonic Heat Meter

### TECHNICAL DATA SHEET (RC 12 DN 15 – DN 40)

#### Product Specifications

- Designed for measuring heat consumption in residential and district heating systems;
- Certified according to MID: DE-13-MI004-PTB010;
- Compliant with PN-EN 1434 standards;
- The battery has a service life of 12 years;
- High accuracy and high measurement stability across the entire flow range;
- Low start-up threshold;
- Does not require straight measurement sections behind and in front of the flow transducer,
- both for horizontal and vertical installations;
- Can be installed in any position on the installation;
- Compatible with the EN 13757 communication protocol and
- MODBUS RTU, possibility of using a radio module;
- Types of communication: optical interface, pulse output, MBUS, 485;
- The uniquely designed display can be adjusted vertically within a range of 0-120° and can
- be rotated horizontally within a range of 0-350°, making it easier for the user to read the data.



	DN15		DN20		DN25		DN32	DN40
L	110	130	190	160	260	180/260	200/300	
L <sup>1</sup>	111							
L <sup>2</sup>	204	234	294	280	380	300	328	
H	82	85		88		91	95	
B	108							

All diameters are given in millimetres.

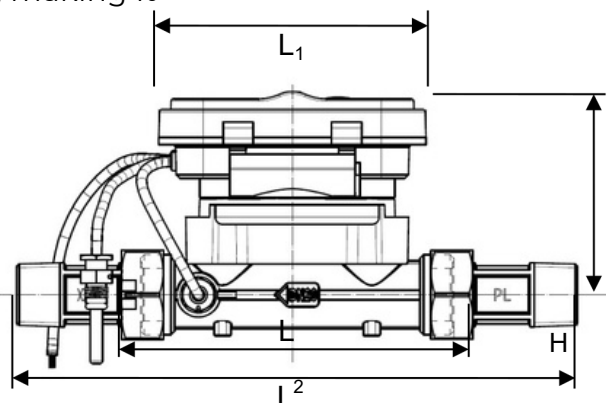

## Technical specifications of the product

Nominal diameter DN (mm)	15		20			25		32	40
Body length (mm) L	110		130	190		160	260	180/260	200/300
Threaded connection (inch)	G 3/4 B		G 1 B	G 1 B		G 1 1/4 B	G 1 1/4 B	G 1 1/2 B R 1 1/4	G 2 B R 1 1/2
Screw connection (inch)	R 1/2		R 3/4	R 3/4		R 1	R 1	13	11
Pressure loss (kPa/qp)	14	18	14	7	17	15	20	6	10
Nominal flow rate qp (m3/h)	0.6	1.5	0.6	1.5	2.5	3.5	6		
Flow rate difference (Qp:Qi)	100:1 (50:1 or 250:1)								
Maximum possible flow rate reading (m3)	999999.99								
Maximum possible heat reading (GJ)	99999999								
Accuracy class	Class 2								
Maximum pressure	1.6MPa								
Heat consumption calculation	start od 0.25K IP65								
Protection class	4~130 °C								
Temperature range	3~60K(2~110K)								
Temperature difference	Class A (5~55°C) or Class B (-25~55°C) optional								
Environmental class	3.6V lithium battery (24VDC for RS485 optional)								
Power supply	12 years								
Battery life									
Mounting position	Pt1000								
Temperature sensors									

### Default communication

Optical interface	Default settings
-------------------	------------------

### Possible communication types

M-Bus RS485	Option to select one communication interface.
Pulse output	
Pulse output and M-Bus	